

Certification and declaration

The **X-trap 50^{1/2}** or **50^{1/2} LED II** complies with the EU-directive on machine safety.
The unit and spare part components are in full compliance with the CE directive and the WEEE / RoHS directives.
The EC declaration of conformity is listed below:

CE declaration of conformity.

We declare, under our responsibility, that the imported product:
Type: **X-trap 50^{1/2}** or **50^{1/2} LED II** insect control unit complies with the following European standards:

Electric insect exterminator/Insect control unit:	
IEC 60335-2-59:2021	Safety of household and similar electrical equipment.
in conjunction with	Part 1: General requirements and
IEC 60335-1:2020	Safety of household and similar electrical appliances.
	Part 2: Particular requirements for insect killers
	This includes the 2014/35/EU Low Voltage Directive (LVD)

Electric insect exterminators:	
IEC 60259:1989+A1:1989+A2:2013	IP classification for the units. (WVP models are IPX5 executed)

Astron LED lamps:	
EN IEC 55015:2019+A11	Directive 2014/30/EU Electromagnetic compatibility (EMC)
EN IEC 61547:2023	
EN IEC 61000-3-2:2019+A1:2020	
EN 61000-3-3:2013+A1:2020+A2:2024	Restriction of hazardous substances (RoHS)
EN 2011/65/EU	

Important warnings

- The appliance is not to be installed by children or persons with reduced physical, sensory or mental capabilities, or lack of experience and knowledge, unless they have been given supervision or instruction.
- Children must be supervised and not to play with the appliance.
- The appliance is to be kept out of reach of children.
- The appliance is not to be used in locations where flammable vapours or explosive dusts are likely to exist.
- If the power cord is damaged, it must be replaced by the manufacturer, its service agent or qualified and licensed electrician in order to avoid a hazard.

Extra attention on the UV Astron LED lamp

The UV Astron LED lamp is developed to guarantee a long a trouble-free lifetime.
The UV Astron LED lamp needs to be cleaned periodically (ideally 4 times per year).
Explanation: As the UV Astron LED lamps become warmer than the conventional UV fluorescent lamps, they attract more dirt and organic particles on its surface. These particles block the UV-A light, which will affect the attraction potential of the UV Astron LED lamp.
Cleaning them with a soapy detergent is therefore essential.

Warning:

- The X-trap 50^{1/2} can only hold the 15 Watt UV lamp (shatterproof lamp)
- The X-trap 50^{1/2} LED can only hold the 9 Watt LED II lamp (shatterproof lamp)
- The 9 Watt LED II lamp has only one live side and must be placed in the correct way (see lamp holder)

Attention

- For indoor use only
- For dry areas only
- Recycle lamps & glueboard

Exploded view

Pos.	Description	Pos.	Description
1	Cover	6	Lamp holder
2	Housing	7	Main plug (power cable)
3	Glueboard (position)	8	Inlay covers
4	Ballast (not for LED)	9	Pivot points
5	UV-A Lamps or UV-A LED lamps	10	Mounting brackets



ENGLISH



X-TRAP 50^{1/2}
X-TRAP 50^{1/2} LED II



Unit / Consumables

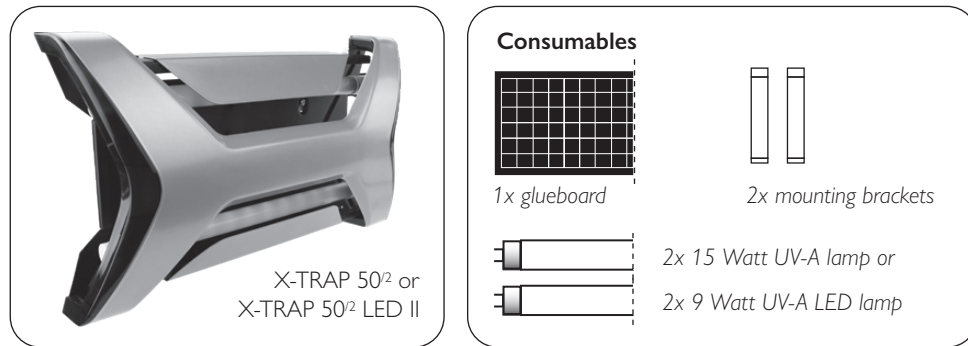

Exploded view (see explanation on back of this manual)

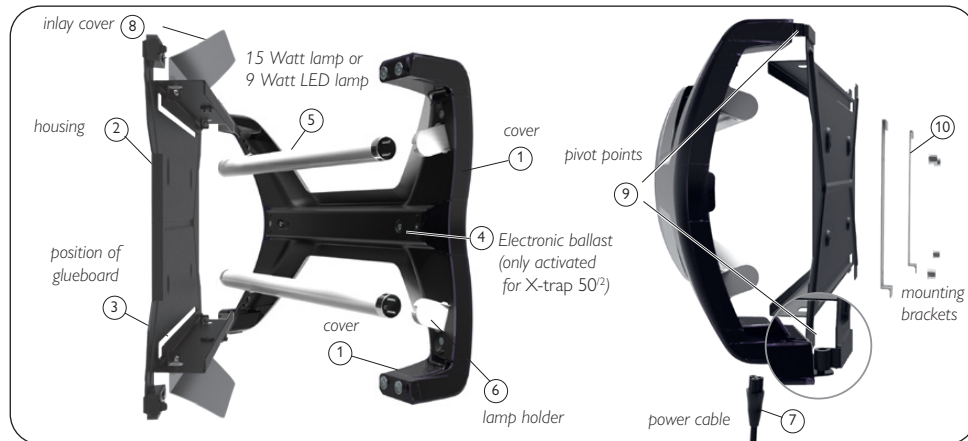

Glueboard install/replace

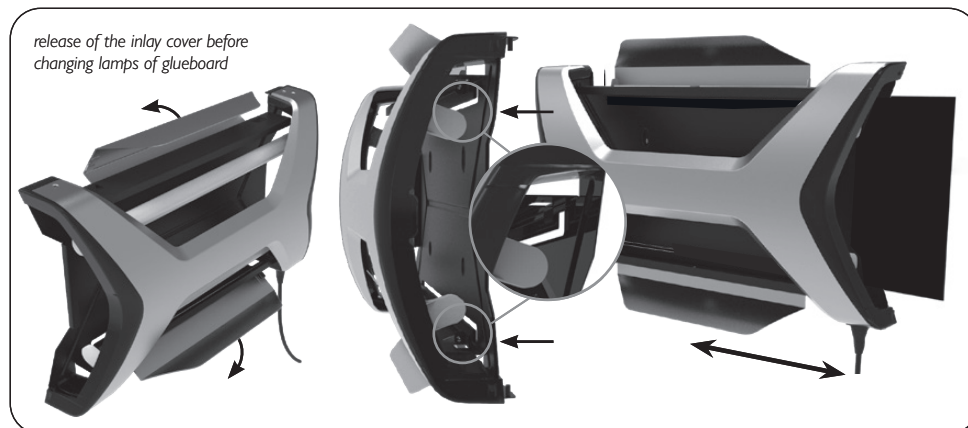

Note: In case of replacement of the glueboard or lamps, use components of the same specifications. Only use genuine spare-parts for service and maintenance.

Wall mounting - in vertical or horizontal position

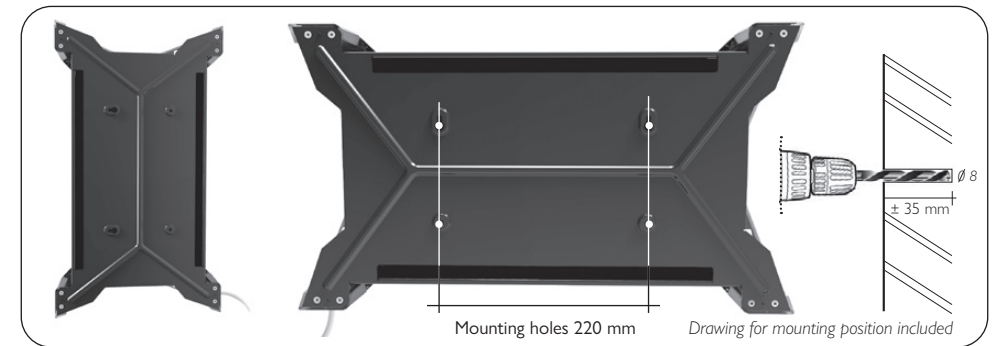

Lamp installation/replacement

ATTENTION!! Place the AC input of the lamp into the LIVE SIDE lampholder

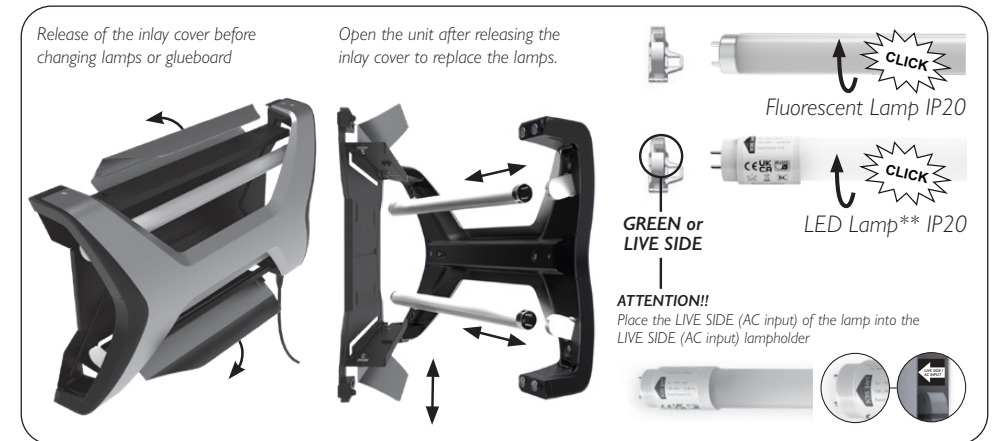

Specifications of the X-trap 50² / X-trap 50² LED II

Area coverage	: up to 80* m ² (100* for LED)
Color	: Anthracite grey
Light source (lamps)	: 2x 15W UV-A or 2x 9W Astron UV-A LED
Type of UV lamps	: UV-A Lamps RoHS certified
Catch specifications	: Temperature optimized glueboard
Power consumption	: X-trap 50 ² : 32 W / X-trap 50 ² LED: 18 W
Weight	: X-trap 50 ² : 4 Kg / X-trap 50 ² LED: 4 Kg
Material	: Full metal chassis and plastic sides
Degree of protection	: IP20 / suited for normal (dry) areas
CE-approval	: Yes
Lamp life time (h)	: X-trap 50 ² : 9,000 - X-trap 50 ² LED: 25,000
Guarantee	: 2-year return to base
Int. building norm	: acc. EN 60335-2-59 int. std. for insect traps
Electrical supply	: X-trap 50 ² : 220-240 V ~ 50 Hz / 110-240 V ~ 50-60 Hz X-trap 50 ² LED 100-240 V ~ 50-60 Hz
Dimensions (L x W x H)	: 538 x 103 x 311 mm / 21.20 x 4.0 x 12.25 inches
Mounting position	: Wall-mounted (horizontal or vertical)

Mounting brackets

